

➔ Coat Check and Lockers

Free coat check and lockers are available. Large bags and umbrellas must be checked or placed in lockers.

➔ Accessibility

Large print labels are available in all galleries. A limited number of wheelchairs are available at the welcome desk.

➔ Family Backpacks

Check out a free Family Backpack at the welcome desk to explore art in the galleries through hands-on activities and art making.

➔ Audio Guide

Discover more about the art on view with the UMFA's free audio guide. Search and download UMFA Audio Guide in the app store, access it by <http://umfa.oncell.com>, or borrow a device from the welcome desk. Connect to UGuest Wi-Fi for access.

Find the  symbol on the wall label next to an artwork and enter the number in the audio guide to listen.

➔ Photography

Photography is allowed for personal use. No flash please. Photography may be restricted in special exhibitions.

Don't forget to share and tag your photos!
#UMFA / @utahmuseumoffinearts

➔ Trailhead, Basecamp, and Lookout

Need a break? Comfy seating, additional art content, and charging stations available at the Trailhead, Basecamp, and Lookout.



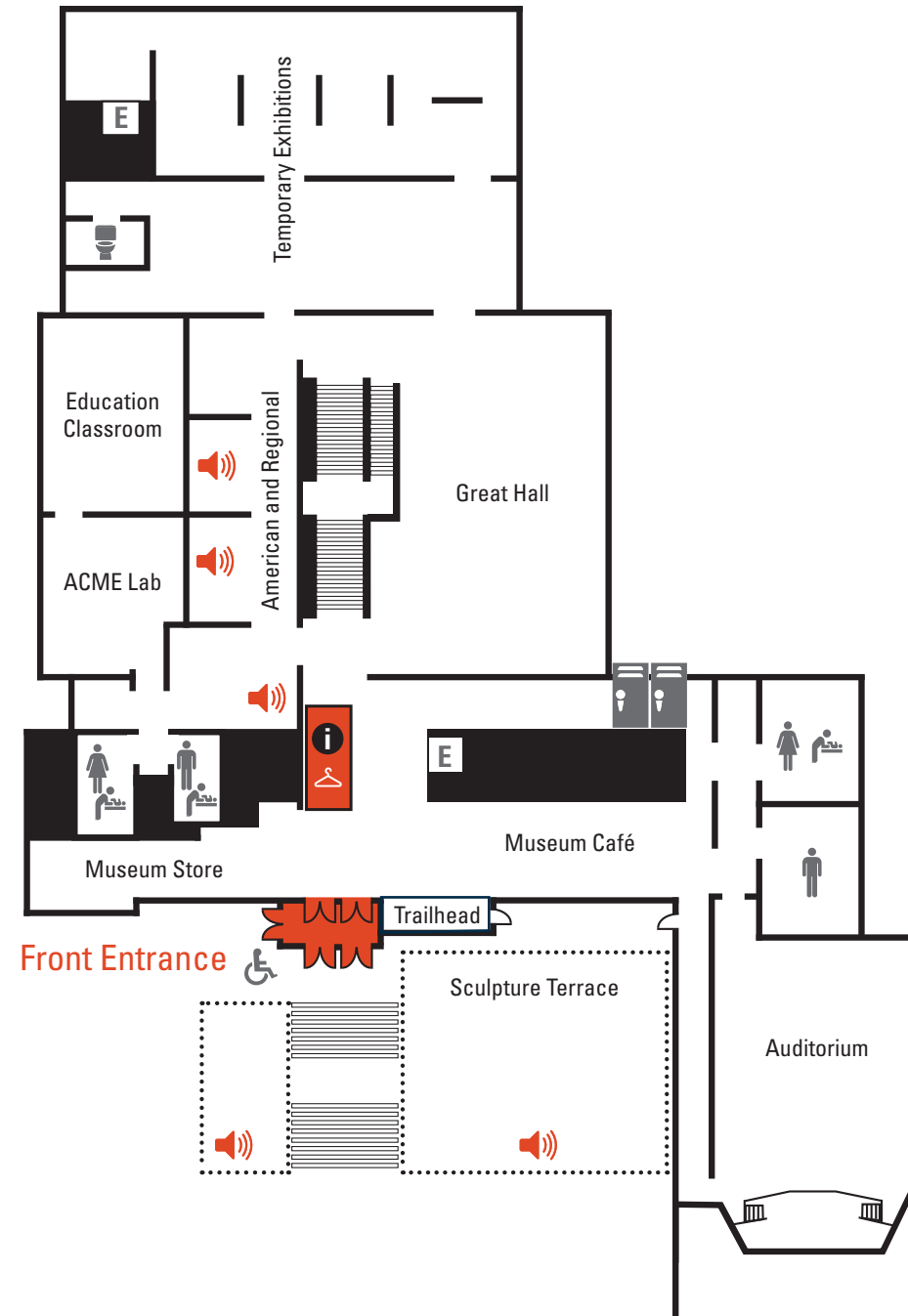

Please help us protect the art. Look but don't touch.
No food or drink in the galleries.

FIRST FLOOR

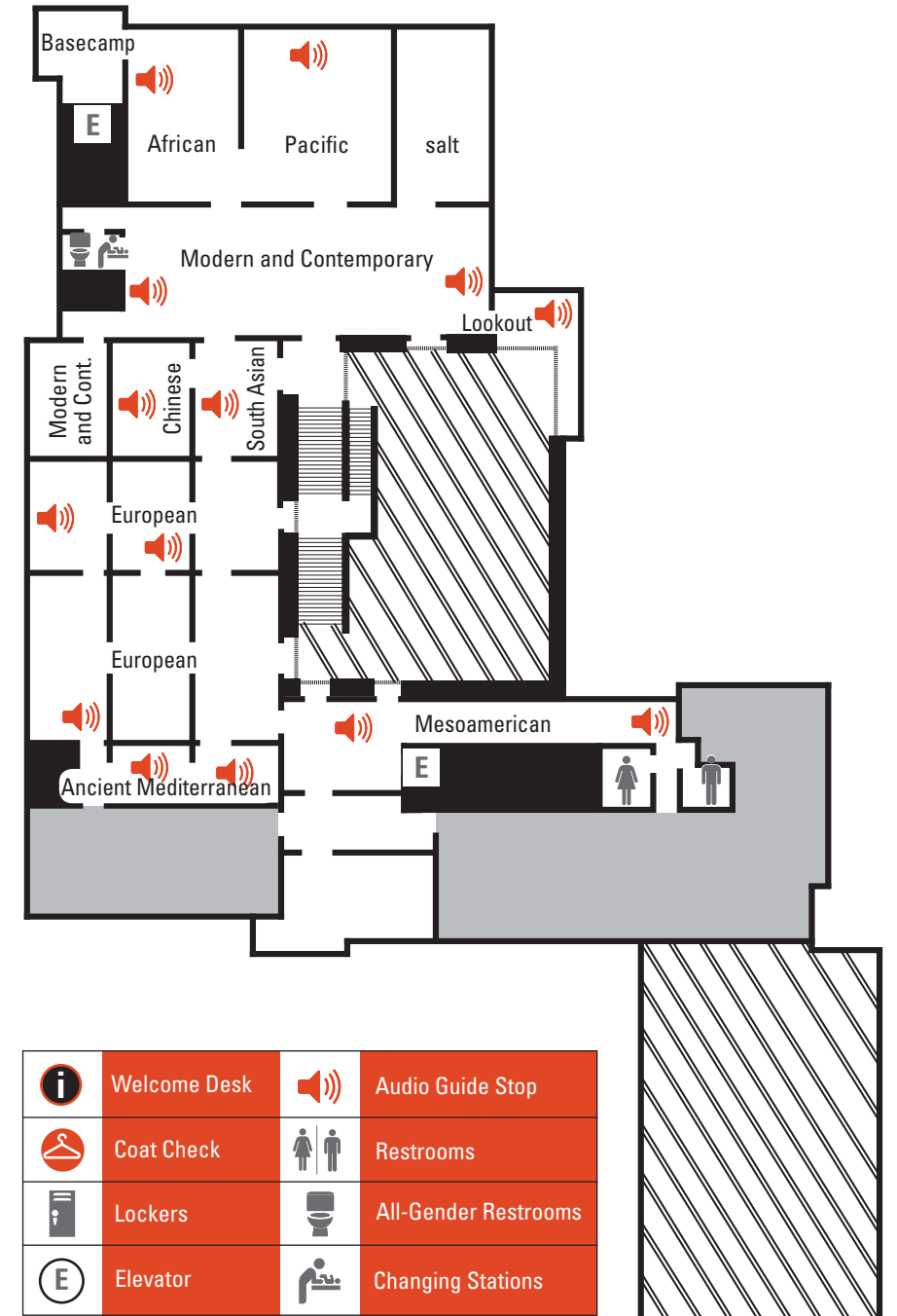

SECOND FLOOR



	Welcome Desk		Audio Guide Stop
	Coat Check		Restrooms
	Lockers		All-Gender Restrooms
	Elevator		Changing Stations